

INSTALLATION GUIDE

PermaTimber®

QuickBoard™ Castellated

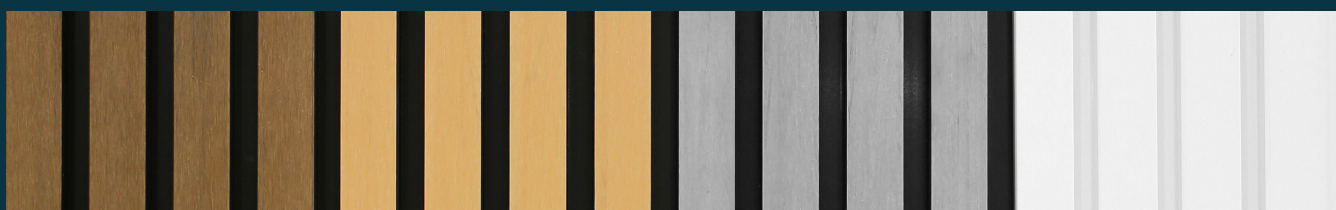

TABLE OF CONTENTS

General Guidelines and Precautions	1
Components	2
Fixing	3
Screws	
Open Beam Roof	
Down Lights	
Cutting	
Expansion Table	4
Installation Guidelines	5
Butt Joints	7
Maintenance	
Trims	8
Gable/ Pitched	
Flat Roof	

GENERAL GUIDELINES AND PRECAUTIONS

Read guide completely before commencing installation.

Correct installation of PermaTimber® QuickBoard™ Castellated will provide years of enjoyment. This product is a ceiling and wall lining that is perfect for ceilings, eaves, interior wall lining and patio/alfresco lining. Quick and easy installation with low maintenance.

Please ensure that you have read these instructions thoroughly prior to and during installation.

Failure to adhere to the installation guidelines will void your warranty. PermaTimber®

QuickBoard™ Castellated is not suitable for use in direct sunlight or where subject to strong reflective sunlight.

PermaTimber® QuickBoard™ Castellated panels are inspected for quality before packaging and shipping. Any defects or damages should be reported to the retailer immediately for inspection. We cannot accept responsibility for panels installed with defects.

Failure to adhere to the following points may void your warranty.

- Installation must be completed in accordance with this guide and all instructions are to be read clearly prior to installation.
- PermaTimber® QuickBoard™ Castellated can vary slightly in colour. For large projects please ensure all materials are ordered together to guarantee that materials are from the same batch.
- PermaTimber® do not recommend mixing 2.7m and 4.8m packs in the same area of installation.
- The customer/ installer is responsible for inspecting each panel for colour, finish, size and other issues prior to installation.
- PermaTimber® QuickBoard™ Castellated can be installed under tin, polycarbonate/ clear roof sheets however a thermal barrier and a gap of 300mm is required. *See diagram below.*
- Failure to provide clearance holes to allow for expansion and contraction will void your warranty.
- All fixing points near electrical sources should be safe and isolated from power. Use a licensed electrical contractor.

The wood texture finish of PermaTimber® QuickBoard™ Castellated is similar to that of natural wood surfaces. We recommend laying out panels prior to installation in order to obtain a uniform overall finish.

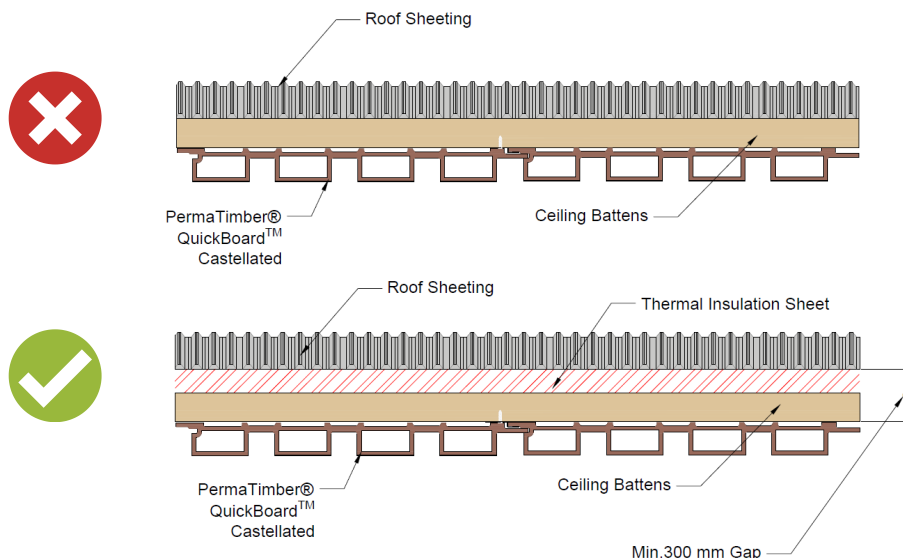

COMPONENTS

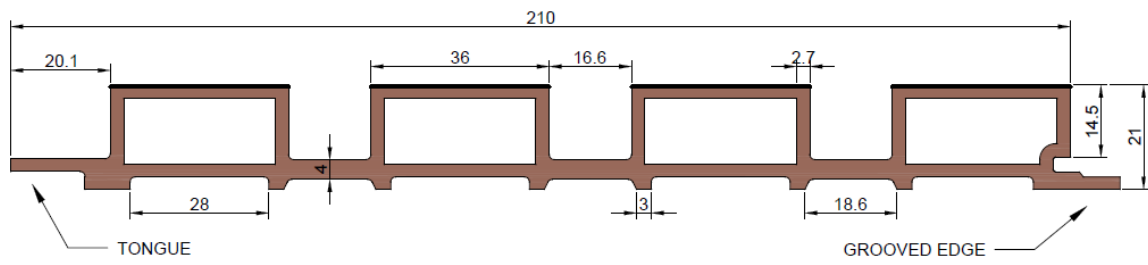

QuickBoard Castellated

Equal Angle Corner Trim

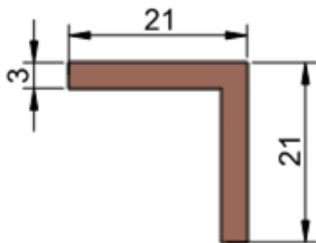

Used for both internal & external corners.

U Edge Trim

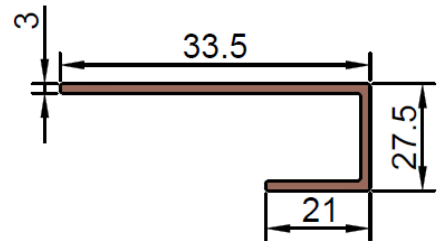

Used for neat edge finishes.

H Joint Trim

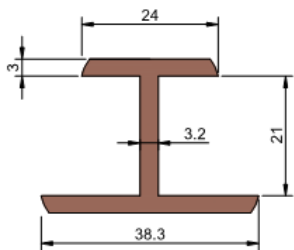

Used for butt joining long runs.

Fixing Clip



Used to fix boards to the battens.

FIXING

PermaTimber® QuickBoard™ Castellated should be fixed onto ceiling joists at no greater than 600mm centres. When fixing we suggest using the following:

SCREWS & CLIPS

Needle point 6 or 8 gauge by 13mm counter sunk screws or equivalent.

Clips are supplied in our 2.7m packs.

Please order clips separately at your retailer if using 4.8m packs.

OPEN BEAM ROOF

It is recommended to install extra battens across sections with a longer span if ceiling battens are greater than 600mm apart.

Batten size will vary with each specific project.

DOWN LIGHTS

Ensure entire working space is safe and isolated from power when working in close proximity to electrical sources.

PermaTimber® QuickBoard™ Castellated must be installed outside of the light housing. If installed over or in contact with light housing, warranty will be void.

Use hole saw with hole cut greater than down light size to cut holes for lights.

Pair LED down lights with PermaTimber® QuickBoard™ Castellated for a sleek finish.

Light fittings should be installed according to manufacturers guidelines and by a licensed electrical contractor.

CUTTING

PermaTimber® QuickBoard™ Castellated panels can be cut along their width and length using basic wood working tools. (i.e. jigsaw with a fine-tooth blade or a fine-tooth drop saw). When measuring for cutting, allow 1mm per 1m length for expansion and contraction of panel.

Please ensure that PermaTimber® QuickBoard™ Castellated is not installed hard up against a rigid surface at ends/ sides and allow minimum 1mm per 1m gap.

Make allowance for contraction and expansion varying on weather. *Refer to expansion table on the next page.* Use PermaTimber® QuickBoard™ Castellated trims to cover the expansion gaps at ends and sides.

Cut outs for down lights and fans can be done with a high-speed hole saw going through the product slowly and steadily.

EXPANSION TABLE

Depending on the temperature exposed, PermaTimber® QuickBoard™ Castellated will expand and contract linearly with a thermal coefficient expansion of $60.662 \times 10^{-6} \text{ 1/}^\circ\text{C}$.

However, due to its unique material composition, the effect of these gaps are minimal.

i.e. only expands/ contracts 2.4mm at $+40^\circ\text{C}$ temperature change.

The unique tongue and groove method with special fixing clips mitigate expansion effects considerably. During installation, it is however important to take note of the ambient temperature and adjust butt joints accordingly.

i.e. 4m panel installed at 20°C can expect to expand by 6mm when the ambient temperature reaches 45°C .

Please refer to the expansion table below before and during installation. **Failure to follow provided gap allowance for expansion/ contraction during installation can void your warranty.**

Gapping Requirements Per Metre	
Change In Temperature ($^\circ\text{C}$)	Expansion/ Contraction (mm)
45	2.7
40	2.4
35	2.1
30	1.8
25	1.5
20	1.2
15	0.9
10	0.6
5	0.3
0	0.0
-5	-0.3
-10	-0.6
-15	-0.9
-20	-1.2

INSTALLATION GUIDELINES

Please complete the following steps to install PermaTimber® QuickBoard™ Castellated.

1. Install the U Edge Trim on the starting edge and one adjoining edge using recommended screw fixing method.
2. Cut off the tongue edge of the first panel. *Refer to Figure 1.0.*
3. Fix your first panel as shown in Figure 2.0. Slot the tongue edge into the trim allowing a 1mm gap for thermal expansion. *Refer to expansion table on page 4.*
4. Fix PermaTimber® QuickBoard™ Castellated into place ensuring panels are screwed into the ceiling joists every 600mm. Attach the fixing clip to the grooved edge and fix with screw into joist. Slot tongue into the next panel. *Refer to Figure 2.0.*
5. Continue the above process to join all PermaTimber® QuickBoard™ Castellated panels to the ceiling or wall until you have covered the entire surface.
6. Ensure the Equal Angle Trim is placed along the length of the panel before installing to the ceiling when fitting the last PermaTimber® QuickBoard™ Castellated panel.
7. Cut 4mm off the wall edge of the last panel to allow adequate space for installation and thermal expansion of Equal Angle Trim to conceal the screws. *Refer to Figure 3.0.*
8. Equal Angle Trim should be glued down with builders construction PVC formulated glue such as Selly's Liquid Nails or similar to fix the last panel in place. *Refer to Figure 3.0.*
9. It is recommended to support trim with painters tape until glue has dried. (Optional)
10. Carefully remove painters tape and enjoy your new look.

Figure 1.0.

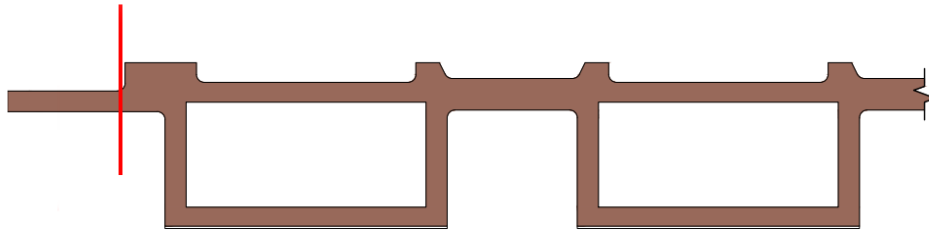

Figure 2.0.

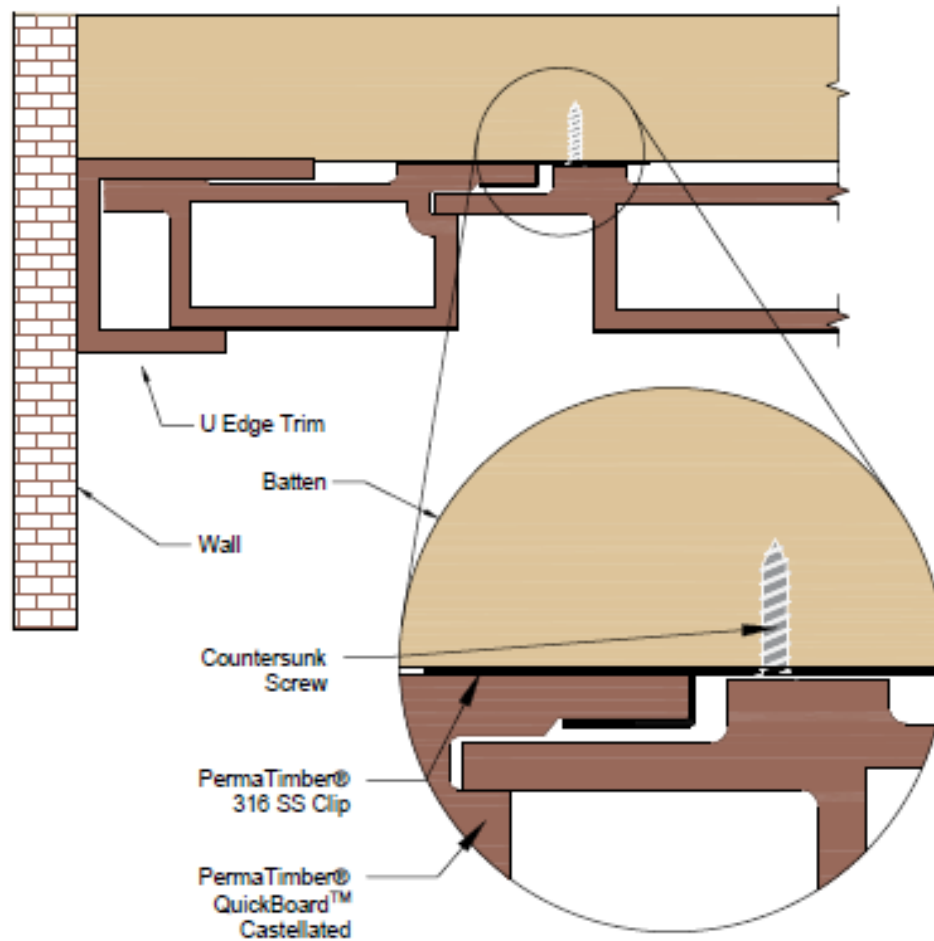
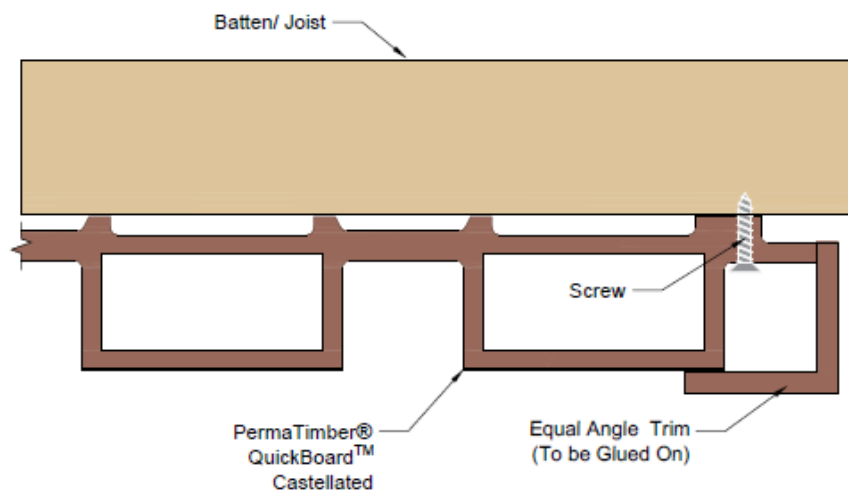

Figure 3.0.



BUTT JOINTS

H-Joints can be used to join panels in longer runs and need to be all in one line. The use of a butt joint on the panels is possible, however, ensure the join is on a batten. A clean straight cut is required for a straight joint or alternatively a 45° scarf cut can be used.

Note that a maximum of 1 butt can be used per run. A H-Joint is required if there are more joins.

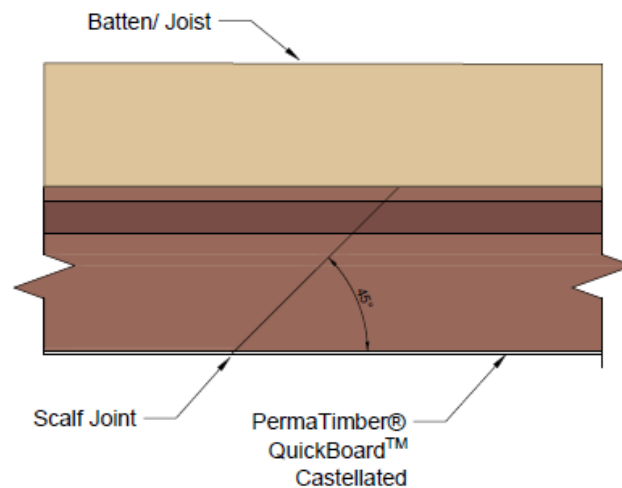

MAINTENANCE

PermaTimber® QuickBoard™ Castellated does not require any ongoing maintenance. If needed, product can be cleaned with a damp cloth or washed off with a low pressure hose. **Do not use pressure hose/ sprayer.**

PermaTimber® QuickBoard™ Castellated can be used for different applications. In each application it is important that the appropriate trim is used.

GABLE/ PITCHED

1. U Edge Trim - used for all exposed edges
2. H Joint Trim - required for long pitches
3. Equal Angle Corner Trim

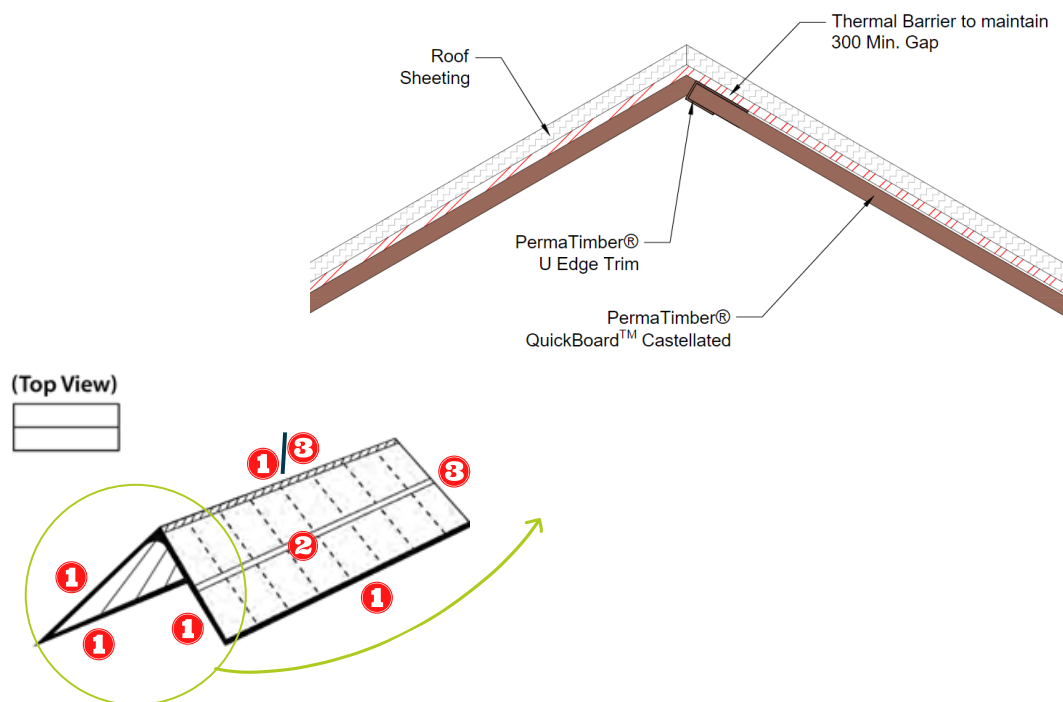

FLAT ROOF

1. U Edge Trim
2. H Joint Trim - if run is greater than 2.4m
3. Equal Angle Corner Trim

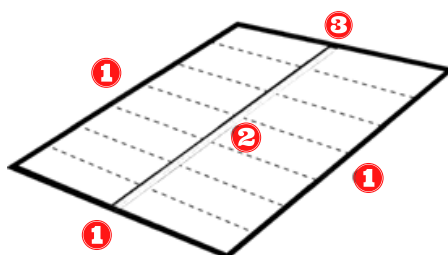



Eco Screening

Eco Cladding

Ceiling & Wall Lining

Decking

PermaTimber® Range

www.permatimber.com.au

